

Access Doors

CAL (Round Duct Type)



At Gerhman we are driven by a strong desire to continuously generate improvements. We do that by developing products and systems that are easy to use and energy efficient, together with industry-leading knowledge, support, logistics and efficient availability.



gerhman.com

Access Doors

CAL



CAL access doors for round ducting consist of two panels connected between themselves with two screws, springs and knobs.

Application

- Assures a tight seal without obstruction in the air system
- Double cam removable duct panel
- Insulated and uninsulated, leak-proof access doors for round ducts
- Provides easy access to sheet metal ducts

Panels	Material	Galvanized steel
Sealing Gasket	Type	High quality EPDM gasket
	Density	+/- 33 kg /m3

Nominal sizes (mm)	Technical Sizes (mm)			
	A	B	C	D
180 x 80	170	72	197	101
200 x 100	200	100	219	117
250 x 150	250	150	274	186
300 x 200	300	200	329	228
400 x 200	380	180	412	212
400 x 300	380	280	403	303
500 x 400	500	400	532	432
600 x 450	600	450	627	480

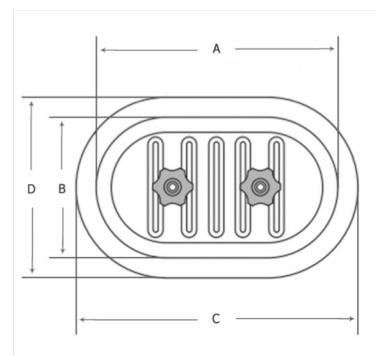

A & B = opening dimensions
C & D = external dimensions

Selection chart

CAL

Door size Duct dia.	180x80 mm	200x100 mm	250x150 mm	300x200 mm	400x300 mm	500x400 mm	600x450 mm	Recommended door curving diameter (mm)
100 mm	Standard	-	+	-	-	-	-	100
125 mm	Standard	-	+	-	-	-	-	125
140 mm	+	Standard	+	-	-	-	-	
150 mm	+	+	+	-	-	-	-	
160 mm	Standard	+	Standard	-	-	-	-	160
180 mm	+	Standard	+	-	-	-	-	200
200 mm	Standard	Standard	Standard	-	-	-	-	
224 mm	+	+	+	-	-	-	-	
250 mm	+	Standard	Standard	-	-	-	-	250
280 mm	+	+	+	-	-	-	-	
300 mm	+	+	+	-	-	-	-	
315 mm	-	Standard	Standard	Standard	-	-	-	315
355 mm	-	-	Standard	Standard	-	-	-	355
400 mm	-	-	Standard	Standard	Standard	-	-	400
450 mm	-	-	Standard	Standard	Standard	-	-	450
500 mm	-	-	Standard	Standard	Standard	-	-	500
550 mm	-	-	-	+	+	-	-	560
560 mm	-	-	-	+	Standard	-	-	
600 mm	-	-	-	+	+	-	-	
630 mm	-	-	-	+	Standard	Standard	-	630
700 mm	-	-	-	-	+	+	-	710
710 mm	-	-	-	-	Standard	Standard	Standard	
800 mm	-	-	-	-	Standard	Standard	Standard	800
850 mm	-	-	-	-	+	+	+	
900 mm	-	-	-	-	Standard	Standard	Standard	900
1000 mm	-	-	-	-	+	Standard	Standard	
1120 mm	-	-	-	-	+	Standard	Standard	1120
1250 mm	-	-	-	-	+	Standard	Standard	1250
1400 mm	-	-	-	-	-	-	Standard	
1500 mm	-	-	-	-	-	-	Standard	
1600 mm	-	-	-	-	-	-	Standard	
1800 mm	-	-	-	-	-	-	Standard	

+ : Available on request
 - : Not available

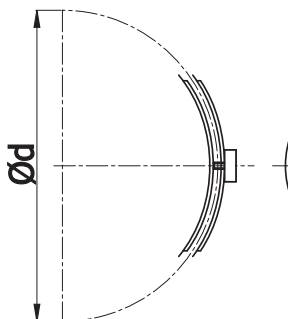

Application

CAL

ROUND DUCTING (CAD)	
Nominal duct diameter (mm)	Minimal size of access door (mm) A x B
$100 \leq D < 200$	180 x 80
$200 \leq D \leq 315$	250 x 150
$315 < D \leq 500$	300 x 200
$500 < D$	400 x 300

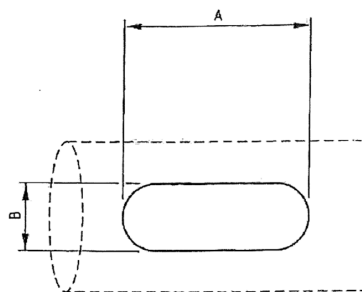

Application

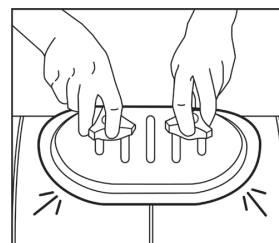
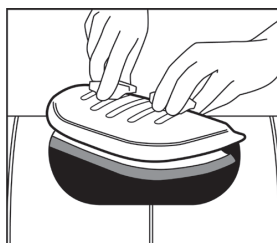
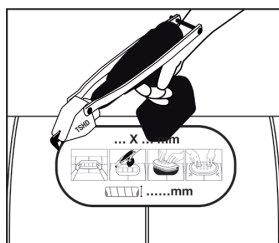
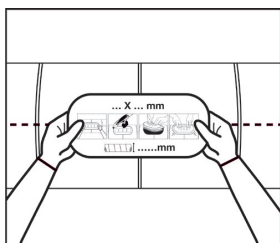

1. Stick self-adhesive template on to duct (a template is provided with each door)
2. Using Turbo Shears or similar cut around template taking care not to exceed the size of the template (the door will function correctly when cut to template size +0 mm -3 mm).
3. Install door by unscrewing the hand knobs until thread is level with top of bolt. Using both hands place the door in the hole at an angle.
4. Turn straight and pull out slightly to align. Then tighten knobs.

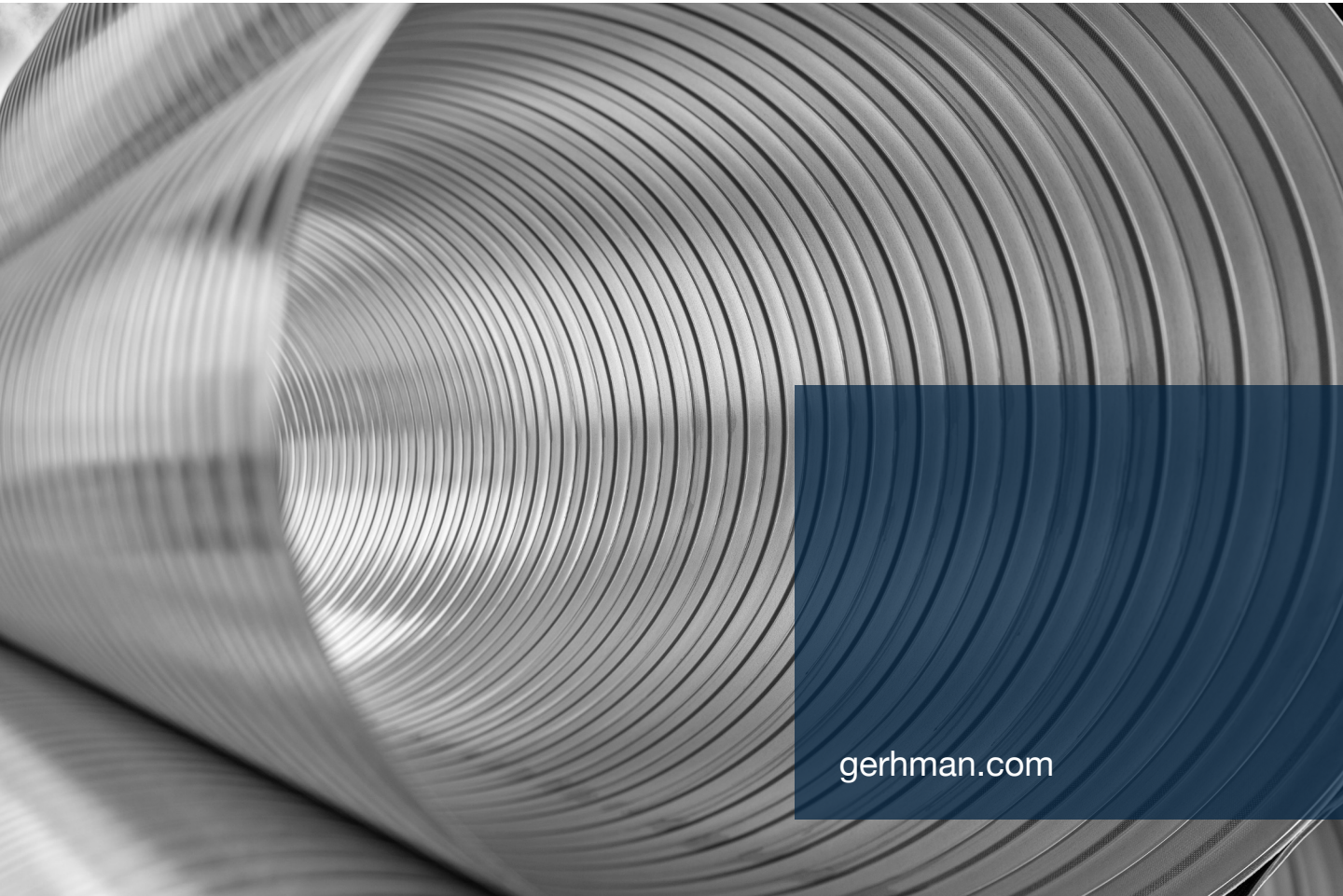

gerhman.com

Access Doors

CAL

 • +90 0850 303 4766

 • info@gerhman.com

 • gerhman.com